

# State of Wyoming Corner Record

(in compliance with the CORNER PERPETUATION AND FILING ACT, Wyoming Statutes, 1977, Section 36-11-101, et. seq., and the Rules and Regulations of the Board of Registration for Professional Engineers and Professional Land Surveyors)

Reverse side of this form may be used if more space is needed.

Record of original survey and citation of source of historical information (if corner is lost or obliterated). Description of corner monumentation evidence found and/or monument and accessories established to perpetuate the location of this corner. Sketch of relative location of monument, accessories, and reference points with course and distance to adjacent corner(s) (if determined in this survey). Method and rationale for reestablishment of lost or obliterated corner.

G.L.O. RECORD: SET AN IRON POST 3' LONG, 1" DIAMETER, 6" IN THE GROUND TO BEDROCK, AND IN A MOUND OF STONE TO TOP, FOR CORNER TO CENTER 1/4 OF SECTION 12 WITH BRASS CAP.

FOUND 2 1/2" G.L.O. BRASS CAP. SET IN 6' WIDE X 2 1/2' TALL MOUND OF STONES ON EAST SLOPE OF DRAW.

173845  
 LARAMIE COUNTY CLERK  
 CHEYENNE, WY.  
 '95 DEC 13 PM 3 55

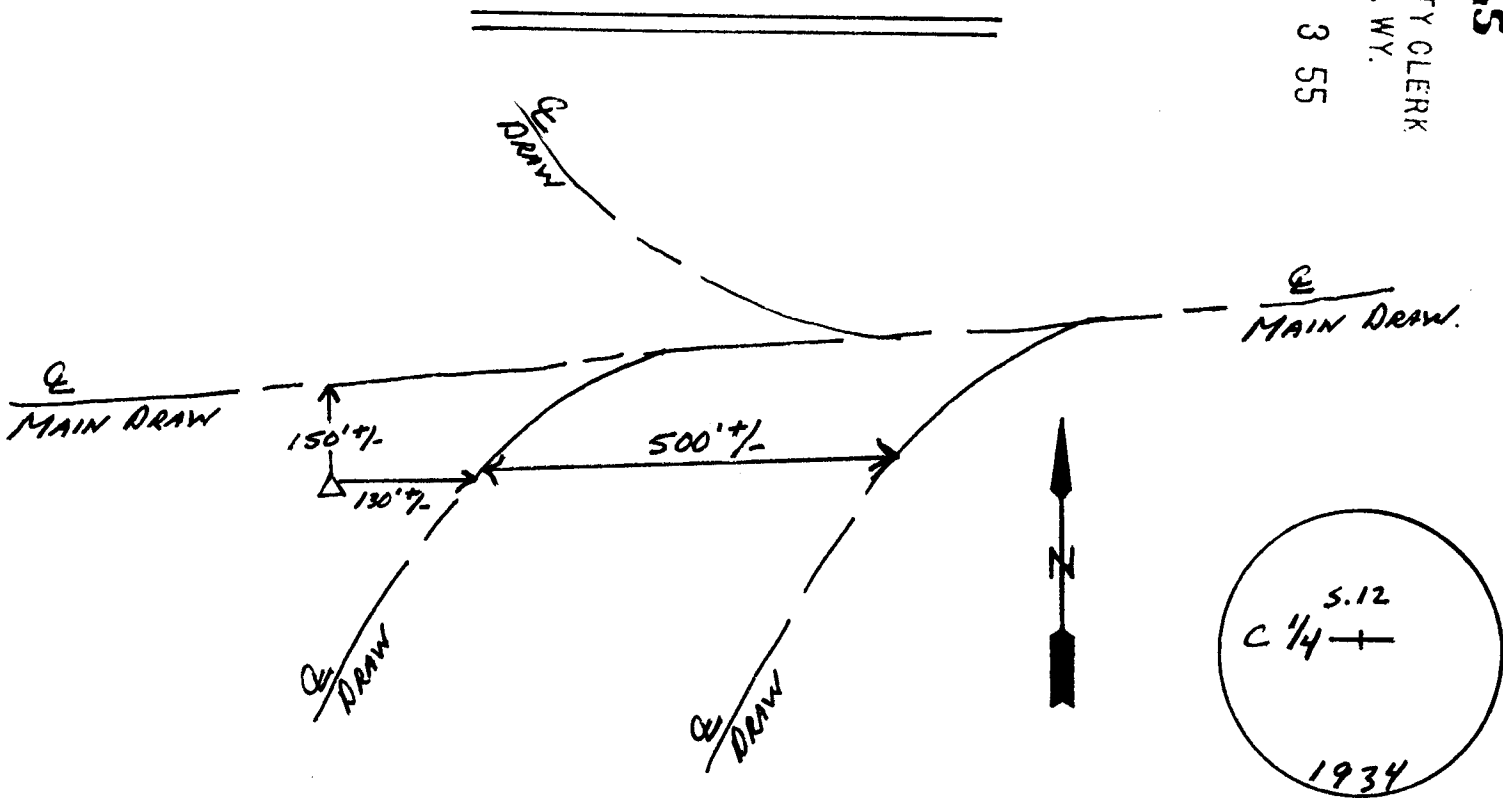

Date of Field Work: 4-11-95 Office Reference: 95097

CROSS INDEX DIAGRAM

A	1	2	3	4	5	6	7	8	9	10	11	12	13	14	15	16	17	18	19	20	21	22	23	24	25
B																									
C	6			5			4				3				2										
D																									
E																									
F																									
G	7			8			9				10				11										
H																									
I																									
J																									
K																									
L	18			17			16				15				14										
M																									
N																									
O																									
P	19			20			21				22				23										
Q																									
R																									
S																									
T	30			29			28				27				26										
U																									
V																									
W																									
X	31			32			33				34				35										
Y																									
Z																									

Firm/Agency, Address  
STEIL SURVEYING SERVICES  
1102 WEST 19th STREET  
CHEYENNE WY 82001  
 Telephone Number: (307) 634-7273

This corner record was prepared by me or under my direction and supervision.  
 SEAL & SIGNATURE

